



The TECNO Evox domestic line units have been designed for a user whose rationale does not want to compromise on quality, underlined by the materials chosen and by careful assembly. Tecno Evox is equipped with a suction inlet integrated in the body of the central unit.

## ■ INSTALLATION ENVIRONMENTS

The **Tecno Evox** central vacuum unit can be installed in homes with the following characteristics:

- Surface to be cleaned between 30 and 450 m<sup>2</sup>
- Use by a single operator
- Pipe network made with 50 mm /2 "diameter pipe
- Power supply 220/240v AC
- Non-continuous use for household suction
- Exhaust air conveyed to the outside
- Installation in places away from heat sources.



## ■ MODEL SELECTION TABLE Tecno Evox

MODELLO	Recommended Surface area	ARTICLE	Recommended inlet points	Max number of operators
Tecno Evox 150	150 m <sup>2</sup>	3110.1TEV	4	1
Tecno Evox 250	250 m <sup>2</sup>	3112.1TEV	7	1
Tecno Evox 350	350 m <sup>2</sup>	3113.3TEV	11	1
Tecno Evox 450	450 m <sup>2</sup>	3115.3TEV	16	1

**energysaving**

## ■ SUMMARY OF CHARACTERISTICS



Vacuum inlet on the machine



IP protection degree



Energy-saving central unit



Insulation class 2



Soft Start start-up



Number of operators simultaneously  
MAX



CE conformity marking

# TECNO EVOX

## DISTINGUISHING PRODUCT DETAILS

### 1 - Service inlet integrated in the machine body

The central units have a convenient **service inlet** in the machine body, to allow cleaning the spaces around the central unit installation.

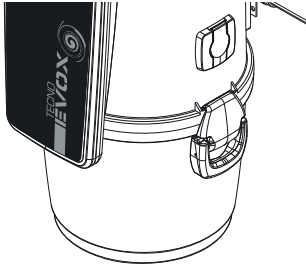

To utilize, just **insert the suction pipe directly into the inlet** itself, without making the micro-switch line connection.

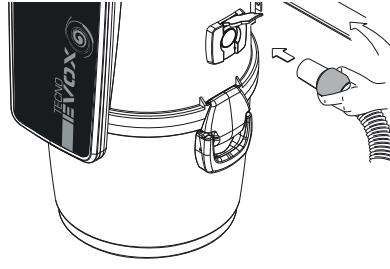

The inlet will be controlled by the **ON / OFF switch** on the front of the central unit.



### 2 - Vacuum breaker valve

On the Tecno Evox line, there is a vacuum **breaker valve** that **prevents the motor from operating in critical conditions** (absence of suction air). It opens automatically, favoring the intervention of the motor thermal protection.

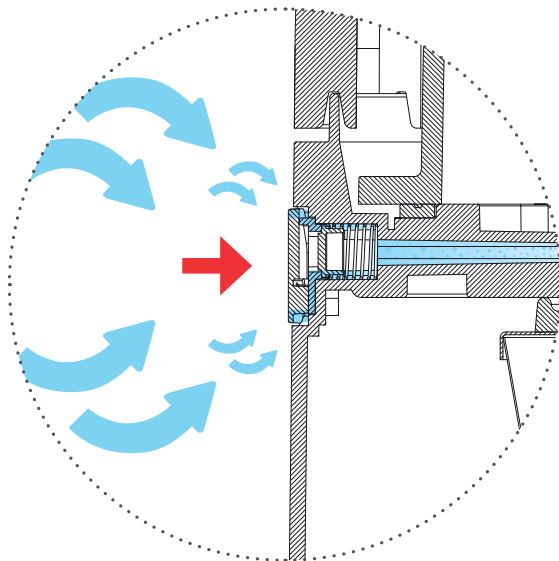

The valve opens automatically and allows the air to flow to the motor

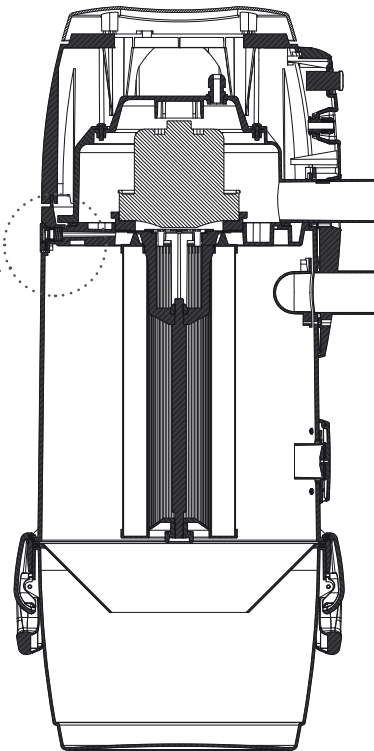

### 3 - Energy saving

The entire range of Sistem Air domestic vacuum units has high efficiency motors, characterized by high performance and low energy consumption which, compared to the past, lead to an average **saving of over 20%**.



■ CENTRAL SECTION Tecno Evox

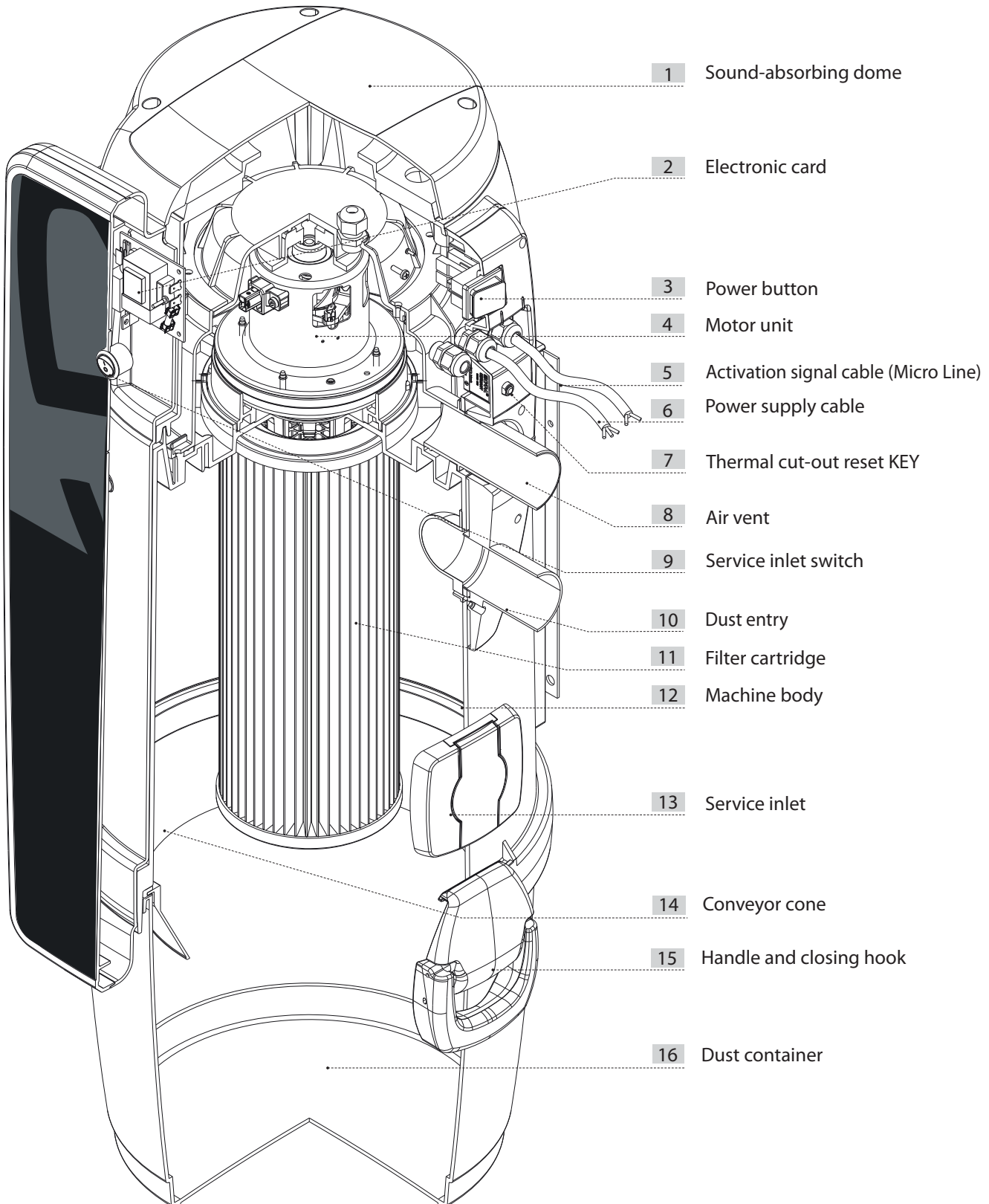

1 Sound-absorbing dome

2 Electronic card

3 Power button

4 Motor unit

5 Activation signal cable (Micro Line)

6 Power supply cable

7 Thermal cut-out reset KEY

8 Air vent

9 Service inlet switch

10 Dust entry

11 Filter cartridge

12 Machine body

13 Service inlet

14 Conveyor cone

15 Handle and closing hook

16 Dust container

# TECNO EVOX

## TECNO EVOX MODEL SELECTION TABLE

The central units can be used by a single operator.

It is recommended to choose the central unit based on the total surface to be cleaned, in order to guarantee maximum duration and performance over time.

Further selection criteria may include the overall dimensions of the unit, dust container capacity and filter surface area.

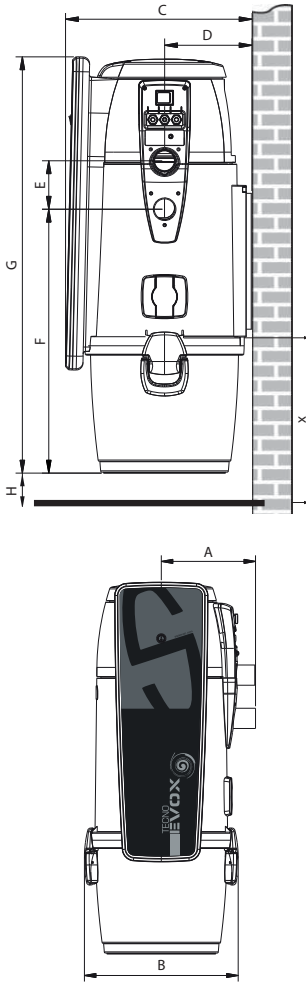

TECNO Evox		TECNO Evox 150	TECNO Evox 250	TECNO Evox 350	TECNO Evox 450
Model Article		3110.1TEV	3112.1TEV	3113.3TEV	3115.3TEV
		On board suction inlet	YES	YES	YES
Suction / exhaust connection	Ø mm	50	50	50	50
Degree of protection	IP	20	20	20	20
Supply	V ac	220/240	220/240	220/240	220/240
Frequency	Hz	50/60	50/60	50/60	50/60
Motor power	kW	1,25	1,35	1,45	1,50
Consumption	A	5,0	5,6	6,3	6,7
Power inlets	V dc	12	12	12	12
Maximum air flow rate	m <sup>3</sup> /h	200	234	240	180
Depression max	mbar	274	272	310	400
Filtering surface	cm <sup>2</sup>	6700	6700	6700	6700
Dust container capacity	l	21	21	21	21
Air vent		YES	YES	YES	YES
Air exhaust silencer (Ø 50 mm)		YES	YES	YES	YES
Weight	kg	17	17	17	18
Measurement A	mm	233	233	233	233
Measurement B	mm	380	380	380	380
Measurement C	mm	412	412	412	412
Measurement D	mm	193	193	193	193
Measurement E	mm	107	107	107	107
Measurement F	mm	583	583	583	583
Measurement G	mm	919	919	919	919
Measurement H (min.)	mm	100	100	100	100
Measurement X (min.)	mm	500	500	500	500
Noise level lower than	dB(A)	70			

**N. B.:** nominal noise values. The values may vary depending on the environment in which the central unit is installed and the type of installation

## CERTIFICATION

IP protection degree

IP 20

Degree of electrical insulation



CLASS II

TECNO EVOX Line

**Appliances comply with the following standards:**

RELEVANT EEC DIRECTIVES:

- 2006/42/CE
- 2006/95/CE
- 2004/108/CE

APPLIED HARMONIZED STANDARDS:

- EN 60335-1 : 2012
- EN 60335-2-2 : 2010
- EN 61000-3-2 : 2006 + A2 : 2009
- EN 61000-3-3 : 2008
- EN 55014-1 : 2006 + A1 : 2009
- EN 55014-2 : 1997 + A2 : 2008
- EN 62233 : 2008

ROHS DIRECTIVE 2002/95

COMPLIANT WITH REACH DIRECTIVES

**N.B.:** as far as the installation phase is concerned, meticulously follow the rules in force.

## TECHNICAL FEATURES

The Tecno Evox line plants are built with plastic materials, PP and ABS, so as to give the structure strength and durability while maintaining an attractive appearance. They have been designed according to all the criteria that the current regulations and the community directives impose, without neglecting fundamental elements such as functionality, power and useability.

The main technical features are listed as follows:

- Cylindrical self-supporting polypropylene body.
- Protection and covers in polypropylene and ABS.
- Dust collection bucket in polypropylene with PA6 nylon handles (21L capacity).
- Sound-absorbing motor compartment (central noise values within 70 dB A).
- Possibility of connecting the pipes either from the right or from the left.
- Motor-impeller group, consisting of single-phase electric motor with brushes and impeller pack (see individual models).
- Vacuum breaker valve for motor protection.
- Filter class M filter cartridge in polyester, washable with water.
- Double protection electronic control board with circuit breakers both on primary and secondary circuits.
- Soft Start system with integrated module on the microprocessor board, specific for suction systems, with current control.
- Thermal safety probe to protect the motor unit, with automatic shutdown and reset.
- 12v DC suction inlet supply.
- Central unit complete with silencer and sleeves for connection to the pipe network.
- Central unit suitable for use with all Sistem Air accessories.

## PERFORMANCE CHARTS

Depression mbar TECNO Evox 150

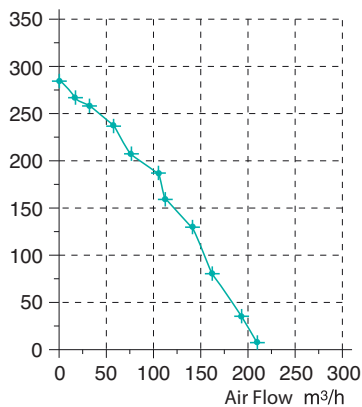

Depression mbar TECNO Evox 250

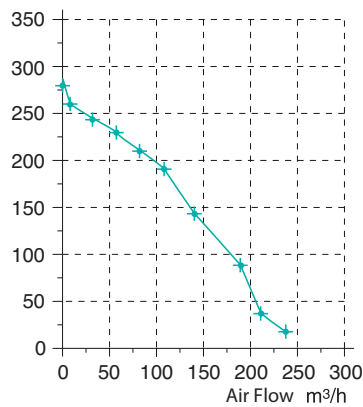

Depression mbar TECNO Evox 350

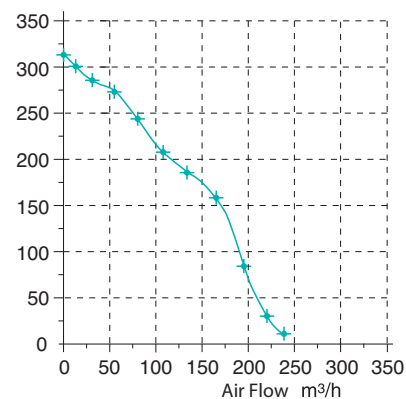

Depression mbar TECNO Evox 450 (motor by-pass)

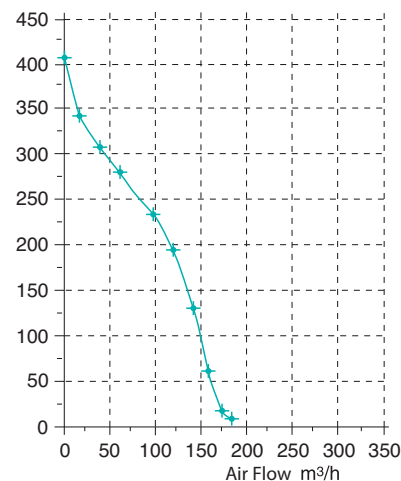

# TECNO EVOX

## ■ INSTALLATION PRINCIPLES

The central units are equipped with a connection to the air vent pipe, a necessary condition to be able to expel the micro dust that the filter cartridge cannot contain.

It must be installed in service rooms (such as garages, cellars or similar), protected from weather, humidity and excessive temperature changes. It is necessary to choose installation sites away from heat sources, such as stoves or radiators. (N.B: IP 20 protection degree). It is always advisable, during the design phase, to carry out measurements in order to design the ideal positioning of the plant, taking into consideration reasonable spaces for installation, use and maintenance.

In the case of a multi-level system, installation is always recommended at the lowest level.

When, for particular installation requirements, the central vacuum unit is located on the upper floors of the building compared to the pipe network (attics, roof spaces, etc.), a central unit of a higher category must be used relative to the actual cleaning surface (consulting the Sistem Air Design Office is advisable).

## ■ CENTRAL UNIT MOUNTING

The central units are hung on a support bracket present in the central unit itself. The latter must be firmly and permanently fixed to the wall by using appropriate plugs, bearing in mind that the overall weight to be supported can be considerably greater than the weight of the control unit alone (see Technical Data tables page 28).

**N.B. The central unit must be fixed so that the bucket is more than 10 cm from the ground.**

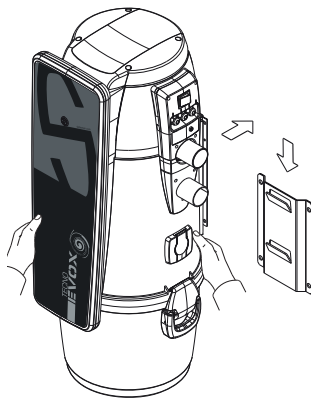

## ■ REVERSIBILITY OF CONNECTIONS

All Tecno Evox control units are designed to be **connected to the piping network both on the right and on the left**. The transformation is quick and easy.

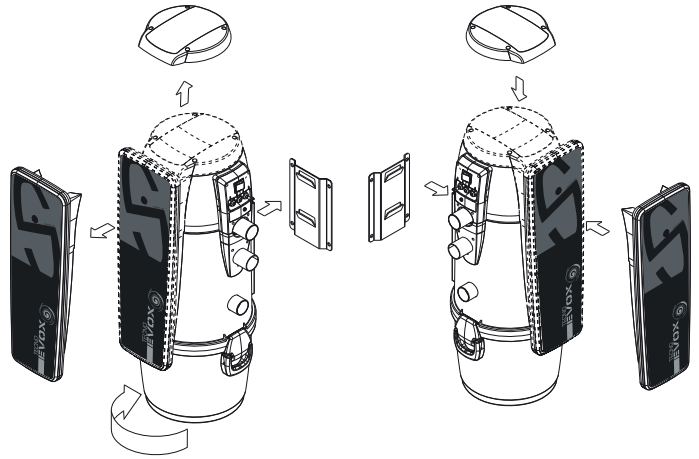

## ■ PIPE NETWORK CONNECTION

The Tecno Evox line units are supplied complete with a Ø 50 mm exhaust silencer, anti-vibration sleeves and clamps for connection to the pipe network.

**ATTENTION: in the case of exhaust piping over 5m in length, it is necessary to install a larger diameter (eg 63 mm) pipe, in order to create the optimal conditions for exhaust air expulsion.**

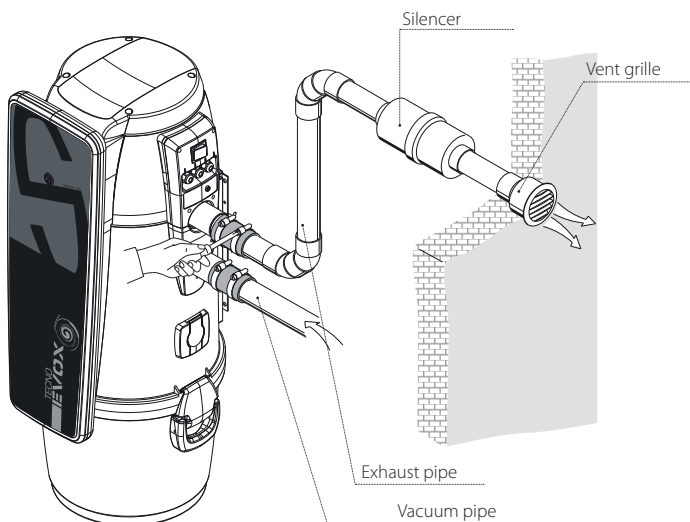

## ELECTRICAL CONNECTION

For installation, meticulously comply with the regulations of CEI standards and the national electricity supplier.

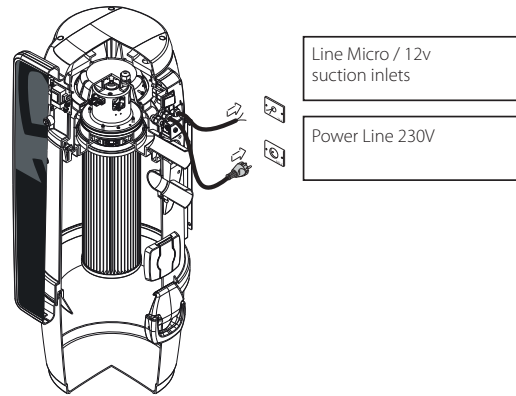

## MAINTENANCE AND ASSISTANCE

For the scheduled maintenance of the central units, the instructions contained in the technical manual supplied with the unit must be followed. In particular, these periodic operations mainly concern filter cleaning, dust collection container emptying, the verification of the correct electric motor operation and the possible obstruction of the air discharge. All interventions not included in the maintenance operations scheduled by the end user must be performed by qualified personnel.

We invite you to consult our website [sistemair.com](http://sistemair.com) for more information on maintenance and the nearest assistance service.



The Tecno Evox line is a synthesis of power and reliability, intended for those looking for an essential product but not willing to compromise on quality.

